

QPL-24787-12 CMC™ Hose End Fittings

90° Dogleg

For MIL-H-24136/2 Type E, MIL-F-24787/5 Group XI, Type D

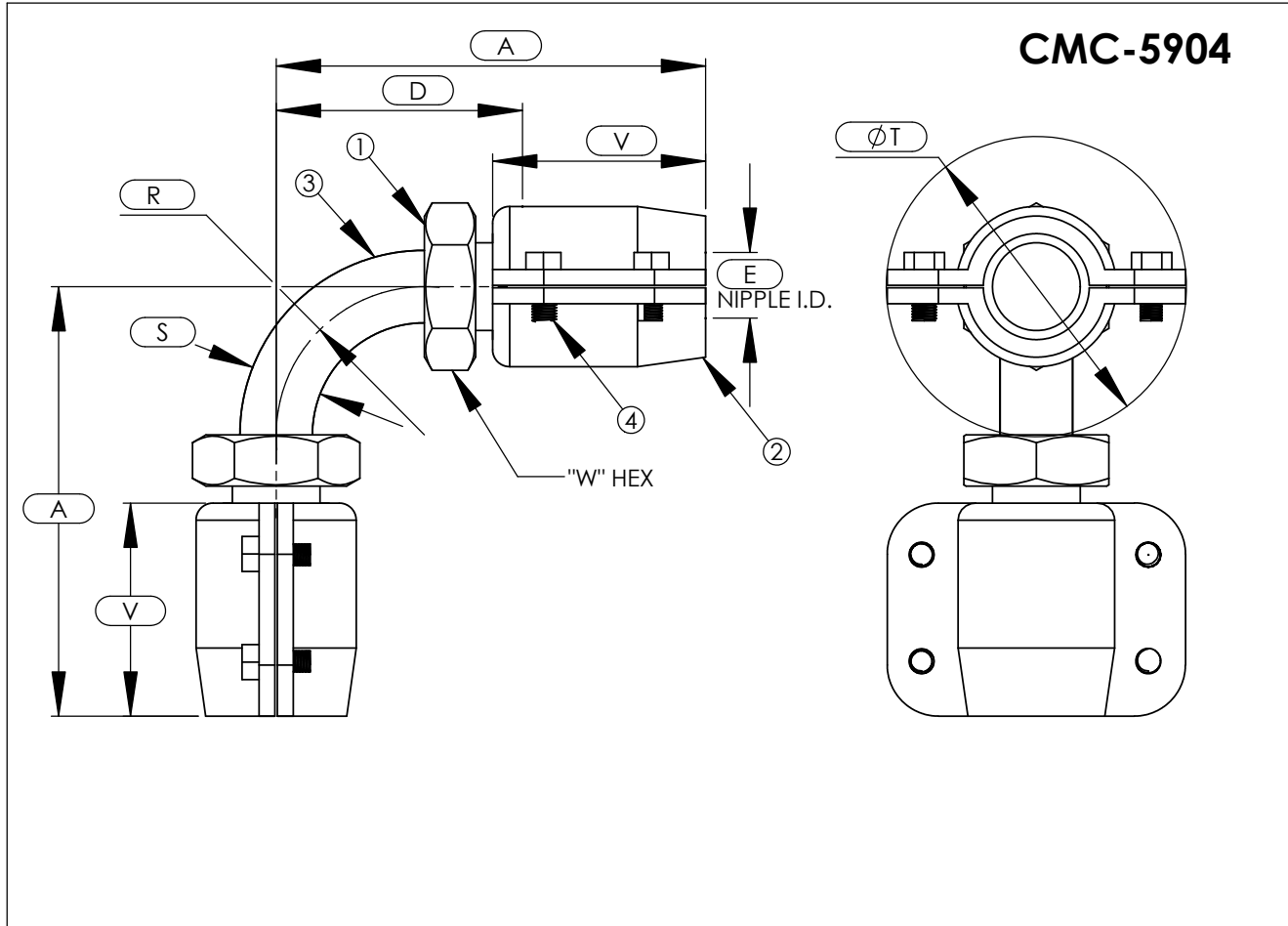

ASSY PART NUMBER	HOSE I.D.	A	D	E	R	S	T	V	W
CMC-XX-5904-06-06	3/8*	3.20	1.58	0.26	0.50	0.38	2.34	2.00	0.94
CMC-XX-5904-08-08	1/2*	3.56	1.84	0.39	0.75	0.50	2.66	2.10	1.00
CMC-XX-5904-12-12	3/4*	4.51	2.61	0.61	1.25	0.75	3.27	2.42	1.31
CMC-XX-5904-16-16	1	4.76	2.85	0.82	1.50	1.00	4.02	2.42	1.62
CMC-XX-5904-20-20	1 1/4	5.50	3.40	1.05	1.75	1.25	4.31	2.80	2.00
CMC-XX-5904-24-24	1 1/2	5.96	3.66	1.30	2.00	1.50	4.69	3.01	2.25
CMC-XX-5904-32-32	2	7.60	4.52	1.75	2.50	2.00	5.65	3.88	2.75

B.O.M.

COMPONENT PART NUMBERS

- ① ALL SIZES-.....NI-5904-(TUBE SIZE)-(HOSE SIZE)-(MATL CODE)
- ② ALL SIZES-.....CL-10-(HOSE SIZE)-(MATL CODE)
- ③ MONEL- SIZES 6 THRU 12.....TUBE
- ③ COPPER NICKEL- SIZES 16 THRU 32.....TUBE
- ④ K-MONEL- ALL SIZES.....BT-(SIZE)-(LENGTH)-(MATL CODE)

-EXAMPLE-
CMC-XX-5904-06-06

SEE PAGE 2 FOR ASSY MATERIAL DESIGNATIONS.

* REQUIRES 2 BOLTS
ONLY PER SOCKET.

