

# CMC® Hose End Fittings

# Straight Flange

Per MIL-H-24136/3 Type All  
 MIL-F-24787/1 Group VIII, Type F  
 MIL-F-20042 150 Lb Flange (with 400 Lb Thick Flange)

QPL-24787-12

## CMC-5121

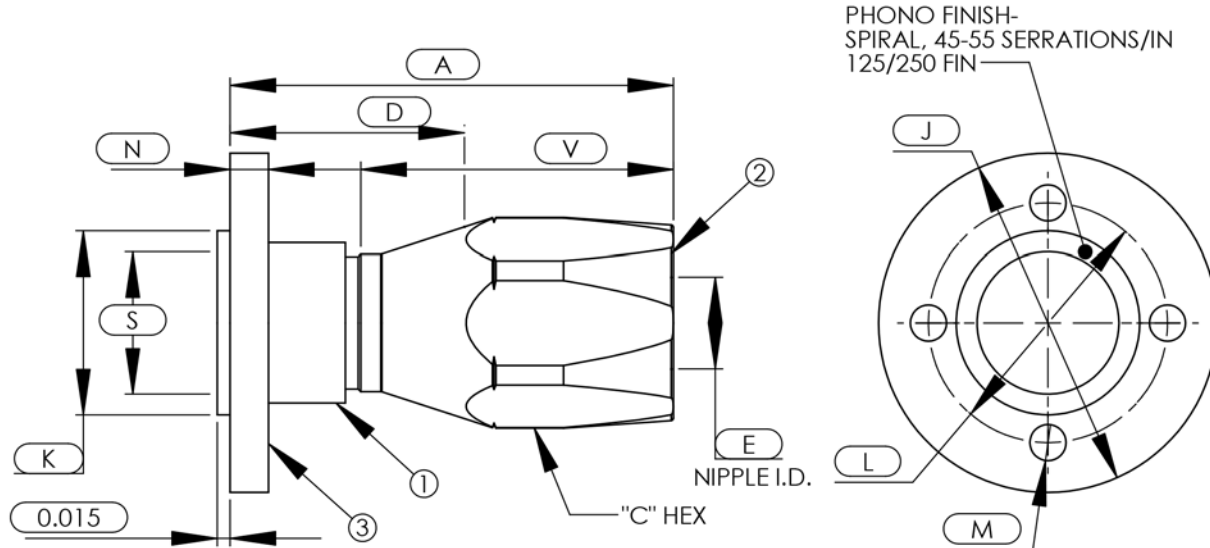

PART NUMBER	NPS SIZE	NO. OF BOLTS	A	C NOM	D	E	J	K	L	M	N	S	V
CMC-XXX-5121-1/2-16	1/2	3	2.80	1.44	1.53	.82	3.56	1.50	2.44	.56	.69	.71	1.66
CMC-XXX-5121-3/4-16	3/4	4	2.80	1.44	1.53	.82	3.81	1.50	2.69	.56	.69	.71	1.66
CMC-XXX-5121-1-16	1	4	2.80	1.44	1.53	.82	4.25	1.50	3.13	.56	.75	.71	1.66
CMC-XXX-5121-3/4-20	3/4	4	2.89	1.75	1.53	1.05	3.81	1.84	2.69	.56	.69	.92	1.75
CMC-XXX-5121-1-24	1	4	2.92	1.94	1.47	1.16	4.25	2.12	3.13	.56	.75	1.18	1.84
CMC-XXX-5121-1-1/4-32	1-1/4	4	3.51	2.44	1.66	1.69	4.50	2.74	3.38	.56	.81	1.53	2.25
CMC-XXX-5121-1-1/2-32	1-1/2	6	3.51	2.44	1.66	1.69	5.06	2.74	3.94	.56	.81	1.77	2.25
CMC-XXX-5121-2-32	2	6	3.51	2.44	1.66	1.69	5.56	2.74	4.44	.56	.81	1.77	2.25

B.O.M.

COMPONENT PART NUMBERS

- ① ALL SIZES-.....NI-5100-(NPS SIZE)-(HOSE SIZE)-(MATL CODE)
- ② ALL SIZES-.....SO-5001-(SIZE)-(MATL CODE)
- ③ ALL SIZES-.....FL-(NPS SIZE)-(HOSE SIZE)-(TYPE)-(MATL CODE)

-EXAMPLE-

CMC-XXX-5121-1/2-16

└─ SEE PAGE 2 FOR ASSY MATERIAL DESIGNATIONS