

# CMC® Hose End Fittings

90° Elbow

Per MIL-H-24136/3 Type BII

QPL-24787-12

MIL-F-24787/1 Group VIII, Type FL

MIL-F-20042 150 Lb Flange (with 400 Lb Thick Flange)

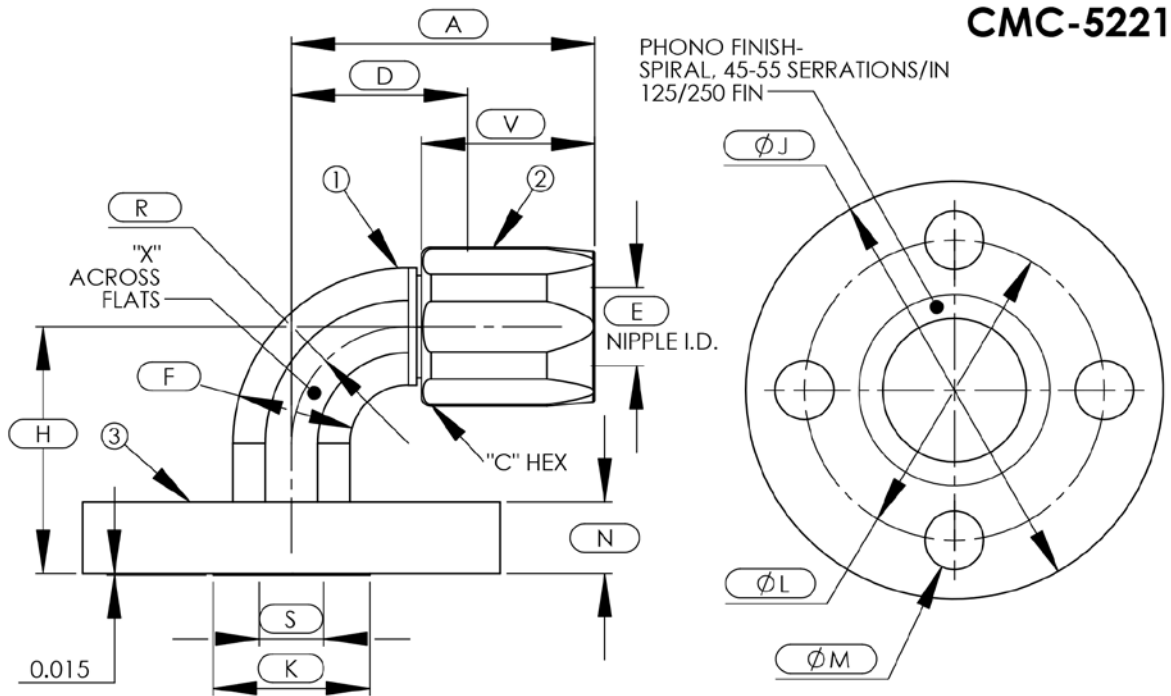

ASSY PART NUMBER	NPS SIZE	NO. OF BOLTS	A	C	D	E	F	H	J	K	L	M	N	R	S	V	X
CMC-XXX-5221-1/2-16	1/2	3	2.80	1.44	1.53	0.75	1.25	2.38	3.56	1.50	2.44	.56	.69	1.12	0.71	1.66	1.19
CMC-XXX-5221-3/4-16	3/4	4	2.80	1.44	1.53	0.75	1.25	2.38	3.81	1.50	2.69	.56	.69	1.12	0.71	1.66	1.19
CMC-XXX-5221-1-16	1	4	2.80	1.44	1.53	0.75	1.25	2.38	4.25	1.50	3.13	.56	.75	1.12	0.71	1.16	1.19
CMC-XXX-5221-3/4-20	3/4	4	2.98	1.75	1.62	1.00	1.62	2.56	3.81	1.84	2.69	.56	.69	1.22	0.82	1.75	1.44
CMC-XXX-5221-1-24	1	4	3.24	1.94	1.78	1.16	1.81	2.75	4.25	2.12	3.13	.56	.75	1.38	1.05	1.84	1.69
CMC-XXX-5221-1-1/4-32	1-1/4	4	3.89	2.44	2.05	1.69	2.44	3.06	4.50	2.74	3.38	.56	.81	1.62	1.38	2.25	2.25
CMC-XXX-5221-1-1/2-32	1-1/2	6	3.89	2.44	2.05	1.69	2.44	3.06	5.06	2.74	3.94	.56	.81	1.62	1.61	2.25	2.25
CMC-XXX-5221-2-32	2	6	3.89	2.44	2.05	1.69	2.44	3.06	5.56	2.74	4.44	.56	.81	1.62	1.77	2.25	2.25

B.O.M.

COMPONENT PART NUMBERS

① ALL SIZES-.....NI-5211-(NPS SIZE)-(HOSE SIZE)-(MATL CODE)

② ALL SIZES-.....SO-5001-(SIZE)-(MATL CODE)

③ ALL SIZES-.....FL-(NPS SIZE)-(HOSE SIZE)-(TYPE)-(MATL CODE)

-EXAMPLE-

CMC-XXX-5221-1/2-16

└──SEE PAGE 2 FOR ASSY MATERIAL DESIGNATIONS