

CMC® Hose End Fittings

90° Elbow

Per MIL-H-24136/3 Type BV
 MIL-F-24787/1 Group VIII, Type FL
 ANSI B16.5 150 Lb Flange

QPL-24787-12

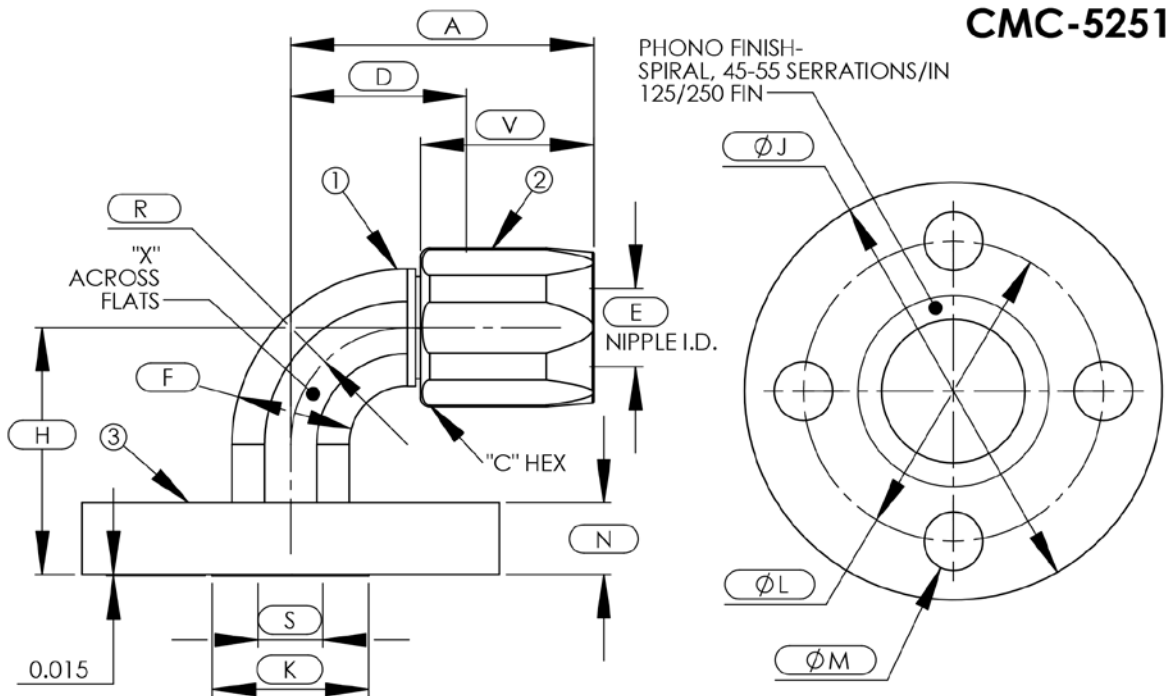

ASSY PART NUMBER	NPS SIZE	NO. OF BOLTS	A	C	D	E	F	H	J	K	L	M	N	R	S	V	X
CMC-XXX-5251-1/2-16	1/2	4	2.80	1.44	1.53	0.75	1.25	2.38	3.50	1.50	2.38	.62	.38	1.12	0.71	1.66	1.19
CMC-XXX-5251-3/4-16	3/4	4	2.80	1.44	1.53	0.75	1.25	2.38	3.88	1.50	2.75	.62	.44	1.12	0.71	1.66	1.19
CMC-XXX-5251-1-16	1	4	2.80	1.44	1.53	0.75	1.25	2.38	4.25	1.50	3.13	.62	.44	1.12	0.71	1.66	1.19
CMC-XXX-5251-3/4-20	3/4	4	2.98	1.75	1.62	1.00	1.62	2.56	3.88	1.84	2.75	.62	.44	1.22	0.92	1.75	1.44
CMC-XXX-5251-1-24	1	4	3.24	1.94	1.78	1.16	1.81	2.75	4.25	2.12	3.13	.62	.44	1.38	1.18	1.84	1.69
CMC-XXX-5251-1-1/4-32	1-1/4	4	3.89	2.44	2.05	1.69	2.44	3.06	4.62	2.74	3.50	.62	.44	1.62	1.53	2.25	2.25
CMC-XXX-5251-1-1/2-32	1-1/2	4	3.89	2.44	2.05	1.69	2.44	3.06	5.00	2.74	3.88	.62	.44	1.62	1.77	2.25	2.25
CMC-XXX-5251-2-32	2	4	3.89	2.44	2.05	1.69	2.44	3.06	6.00	2.74	4.75	.75	.44	1.62	1.77	2.25	2.25

B.O.M.

COMPONENT PART NUMBERS

- ① ALL SIZES-.....NI-5211-(NPS SIZE)-(HOSE SIZE)-(MATL CODE)
- ② ALL SIZES-.....SO-5001-(SIZE)-(MATL CODE)
- ③ ALL SIZES-.....FL-(NPS SIZE)-(HOSE SIZE)-(TYPE)-(MATL CODE)

-EXAMPLE-

CMC-XXX-5251-1/2-16

└─SEE PAGE 2 FOR ASSY MATERIAL DESIGNATIONS